



Marquee Clamp

Product Data Sheet



A standard marquee clamp.

Part Nos	T28870
Fits Beams	50 - 110mm (1.97" - 4.33")
Material	CR4 Mild Steel
Finish	Powder painted black
Max Tightening Torque	Hand tighten only
Weight	1.40Kg (3.08 lbs)
WLL	See Illustration
Factor of Safety	5:1

Dimensions in mm

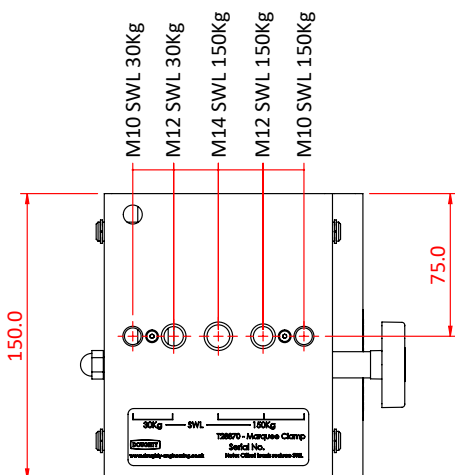
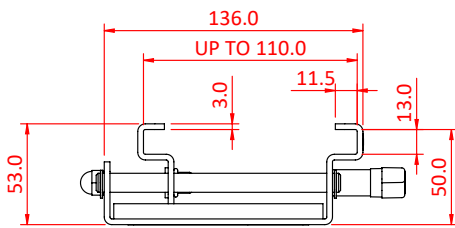

M10 x 1.5 - 150Kg

M12 x 1.75 - 150Kg

M14 x 2 - 150Kg

M12 x 1.75 - 30Kg

M10 x 1.5 - 30Kg

