

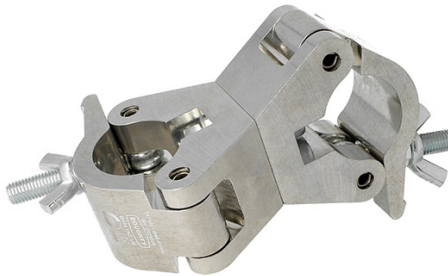

Product Data Sheet

Doughty 90° Fixed Coupler



A pair of half couplers fixed at 90° which provide a firm fixing between two perpendicular bars.	
Part Nos	T57102 - Polished T57112 - Powder Painted Satin Black
Tube Diameter	Ø48 - 51mm (1.89" - 2.01")
Materials	Main Body - AW6082 T6 Aluminium Roll Pins - Stainless Steel Eyebolt Assy - Grade 8.8
Max Tightening Torque	30Nm
WLL	750Kg
Weight	1.33Kg (2.93 lbs)
Factor of Safety	5:1
Approval	TÜV Approved

Dimensions in mm

