

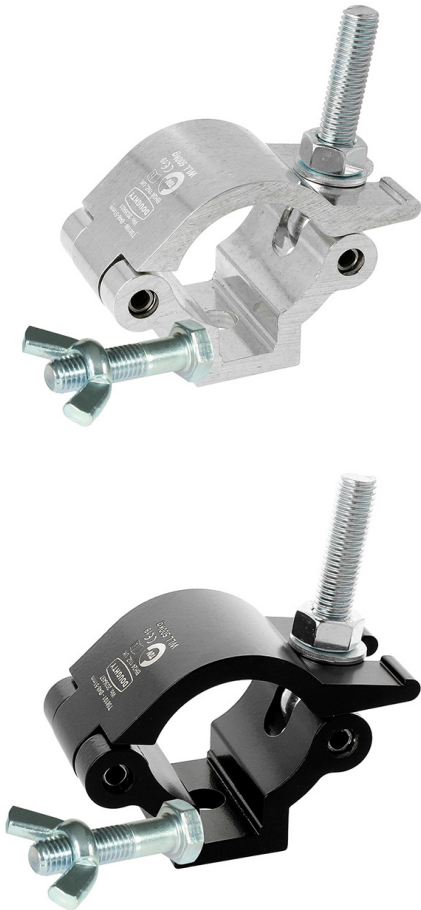

Lightweight Hook Clamp Coupler



Product Data Sheet



A high tensile extruded half coupler supplied with fixing kit	
Part Nos	T58105 - Polished T58106 - Powder Painted Satin Black
Tube Diameter	Ø48 - 51mm (1.89" - 2.01")
Materials	Main Body - AW6082 T6 Aluminium Roll Pins - Stainless Steel Eyebolt Assy - Grade 8.8
Max Tightening Torque	30Nm
Fixings	Supplied with M12x50 Bolt / Wing Nut
WLL	500Kg
Weight	0.42Kg (0.92 lbs)
Factor of Safety	5:1
Approval	TÜV Approved

Dimensions in mm

