

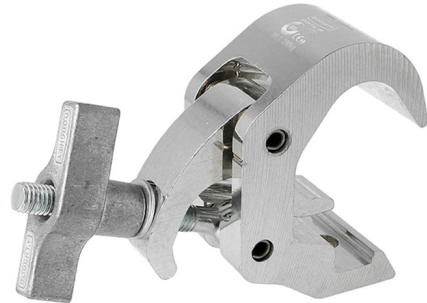

Product Data Sheet

Quick Trigger Clamp



A Quick Trigger Clamp with a slotted body to hold captive an M10 or M12 nut or bolt	
Part Nos	T58200 - Polished T58201 - Powder Painted Satin Black
Tube Diameter	Ø38 - 51mm (1.50" - 2.01")
Materials	Main Body - AW6082 T6 Aluminium Roll Pins - Stainless Steel Eyebolt Assy - Grade 8.8
Max Tightening Torque	Hand-tight Only
Fixings	To be used with M10 or M12 Fixings
WLL	250Kg
Weight	0.71Kg (1.57 lbs)
Factor of Safety	5:1
Approval	TÜV Approved

Dimensions in mm

